

PD-30 AMPLIFIER

Owner's Manual

PRECAUTIONS

PLEASE READ CAREFULLY BEFORE PROCEEDING

⚠ If the product you purchase uses battery, you should pay attention when idle or store it for a long time: to charge the battery when the battery is at low-power status. If the battery keeps low-power status for a long time, its service life will be reduced. The battery should be full-charged if you want to store the product when you don't use it.

⚠ **WARNING:** These instructions are used to remind users that improper use of this product may cause personal danger to you.

⚠ **CAUTION:** These instructions are used to warn users that improper use of this product may result in damage to the equipment.

⚠ WARNING

- ▶ Before using the power supply, connect the power supply port of the device to the power socket with ground protection.
- ▶ Do not disassemble or modify the built-in components of the device and adapter.
- ▶ Use the power adapter or power cable delivered with the device. The power cable or adapter does not apply to other devices.
- ▶ Before use, check whether the rated voltage of the equipment is consistent with the mains voltage. Inconsistent voltages may cause equipment damage or even personal injury.
- ▶ Do not overtwist or bend the power cable, and do not place heavy objects on it. Otherwise, the power cable may be damaged, resulting in short circuit. Broken wires can cause fire and a risk of electric shock!
- ▶ Do not share the same socket with too many appliances. When using an extension cable, take special care that the total power of all the devices you connect to the extension cable should not exceed the power that the extension cable can withstand. Overloading the power supply can cause the wires to heat up and melt the insulation covers of the wires.
- ▶ When inserting or removing the plug of the power cable from the socket, hold the plug of the power cable.
- ▶ Avoid entangling the power cable with various conductors. Also, keep children away from power cords and wires.
- ▶ When hands are wet, do not take the power cord of the device or insert or remove the plug of the power cord from the socket.
- ▶ Before moving the device, unplug the power cable and all external device cables connected to the device.
- ▶ Before cleaning the device, turn off the power and unplug the power cord from the socket.
- ▶ If thunderstorms occur, remove the power plug from the socket.

⚠ CAUTION

- ▶ Do not place the device in the following places:
 1. Places where the temperature is too high (e.g. in a closed vehicle in direct sunlight, near a hot pipe or above a hot machine).
 2. Damp places (e.g. bathroom, toilet, supermarket floor, etc.).
 3. Places with heavy humidity.
 4. Places that are directly exposed to rain.
 5. A dusty place.
 6. Where there are strong tremors.
- ▶ When the following situations occur, please immediately turn off the power and unplug:
 1. The adapter, power cable, or plug is damaged
 2. The device emits smoke or generates odor
 3. The device is directly exposed to rain (or wet)
 4. The device operates abnormally or behaves abnormally

Power Supply:

Do not share a power outlet with other inverter-controlled devices (such as refrigerators, washing machines, microwave ovens, or air conditioners) or electrical devices with motors. Due to the different use methods of electrical equipment, the generated power noise may cause the equipment to fail or produce noise. If a separate power outlet is not available, install a power noise filter between the device and the power outlet.

Top Panel

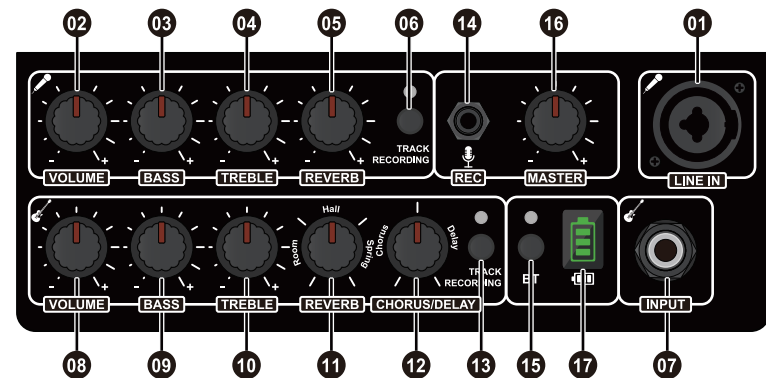

Microphone Part

- 01 **LINE IN INTERFACE:** Microphone jack, which is used to connect devices such as microphones (Compatible with audio cables such as "6.35mm or Canon").
- 02 **MICROPHONE VOLUME KNOB:** Adjust the input volume of the microphone.

- 03 **BASS ADJUSTMENT KNOB**: Adjust the low frequency signal strength of the microphone input.
- 04 **MEDIUM & HIGH PITCH ADJUSTMENT KNOB**: Adjust the medium and high frequency signal strength of the microphone input.
- 05 **REVERB ADJUSTMENT KNOB**: Adjust the reverb effect intensity of the microphone input signal.
- 06 **MICROPHONE RECORD BUTTON**: Press and hold for three seconds to enter the recording status, in order to record the microphone sound to the mobile device.

- 20 **D.I OUTPUT INTERFACE**: Output the music that is played by the speaker to other music devices.
- 21 **OTG RECORDING**: After using a 'Type-C' cable to connect with the mobile phone, it can realize the function of 'Live recording'.
- 22 **HEADPHONE INTERFACE**: After connecting the headphone, it can achieve the function of listening to the speaker.
- 23 **DC INTERFACE**: Used to connect adapters to power the speaker.

Guitar Part

- 07 **GUITAR INTERFACE**: Used to connect devices such as guitars and microphones.
- 08 **GUITAR VOLUME KNOB**: Adjust the input volume of the guitar interface.
- 09 **BASS ADJUSTMENT KNOB**: Adjust the low frequency signal strength of the guitar input.
- 10 **MEDIUM & HIGH PITCH ADJUSTMENT KNOB**: Adjust the medium and high frequency signal strength of the guitar input.
- 11 **REVERB ADJUSTMENT KNOB**: Used to adjust the reverb effect strength of guitar input signal and select reverb mode such as ROOM/CONCERT/HALL/SPRING.
- 12 **CHORUS & DELAY ADJUSTMENT KNOB**: Adjust the effect intensity of the chorus and delay of the guitar input signal.
- 13 **GUITAR RECORD BUTTON**: Press and hold for three seconds to enter the recording status, in order to record the guitar sound to the mobile device.
- 14 **REC INPUT**: Make the REC INPUT work by a 3.5mm audio cable.
- 15 **BLUETOOTH BUTTON**: Long-press to open/clos; short-press to pause/play.
- 16 **TOTAL VOLUME ADJUSTMENT KNOB**: Adjust the input volume for "BLUETOOTH/PHONE/AUX/MIC/GUITAR" .
- 17 **BATTERY INDICATOR**: It shows three cells when the battery is full charged, and the number of cells is displayed according to the power-quantity.

Specifications

Model:	PD-30
Power output:	30W
Power input level:	-56dBu / 10kΩ
Horn:	Low-pitch horn 6.5 Inch High-pitch horn 1.5 Inch
Frequency response range:	20 - 20kHz
INTERFACE	
MIC interface:	6.35mm stereo audio interface
Guitar interface:	6.35mm mono audio interface
OTG(Live) Interface:	Type-C input interface
DC interface:	DC 18V 3A (⊕ → ⊖)
AUX-IN interface:	3.5mmstereo audio interface
Headphone / D.I OUT interface:	6.35mm stereo audio interface
Dimension:	230(L)×180(W)×200(H)mm
Weight:	3.25KG
Power adapter:	DC 18V 3A
Battery capacity:	2200 mAh

Back Panel

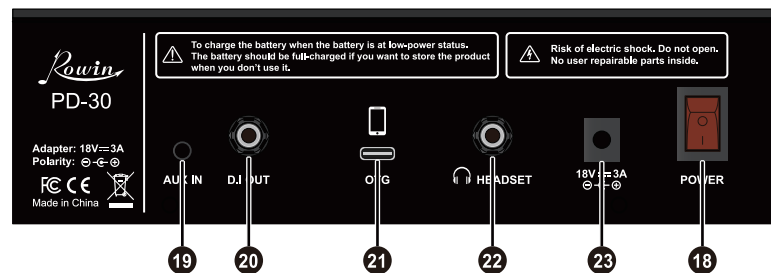

- 18 **POWER BUTTON**: Control power ON/OFF
- 19 **AUX - IN INTERFACE**: Used to access mobile audio devices such as mobile phones or MP3 players.